

Rotating Wheel Remote (2.4GHz)

Model No.: K3 / K3S

Contents

<u>Product Features</u>	2
<u>Product parameters</u>	2
<u>Button Description</u>	3
<u>Install battery</u>	3
<u>Instructions for pairing/clearing codes with lamps</u>	4
<u>Installation Notes</u>	5
<u>Attention</u>	6

1. Product Features

Rotating Wheel Remote, which uses the 2.4GHz frequency band, has low power consumption, long transmission distance, strong anti-interference ability, and fast communication speed. Simply turn the dial on the remote control to enjoy comfortable lighting effects. Compact, easy to use, magnetically mounted and securely attached. Can control designated Mi-Light / MiBoxer 2.4G lamps and adjust the color temperature and brightness of the light.

2. Product parameters

Model No.: K3 / K3S

Working Voltage: 3V (CR2032 battery)

Transmitting Power: 6dBm

Standby Power Consumption: <math><6\mu\text{A}</math>

RF: 2.4GHz

Working Temperature: $-10\sim 40^{\circ}\text{C}$

Control Distance: 30m

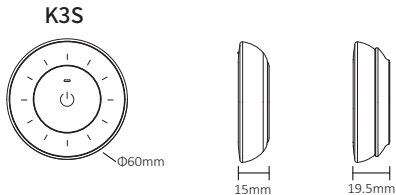
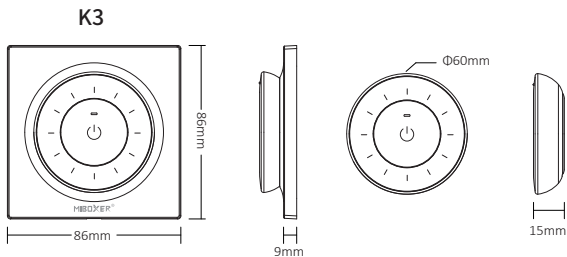

3. Button Description

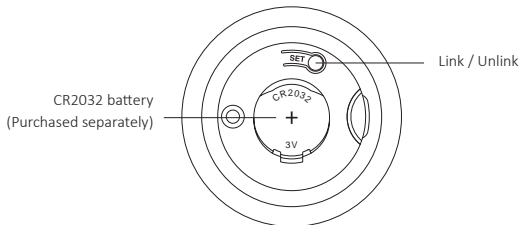
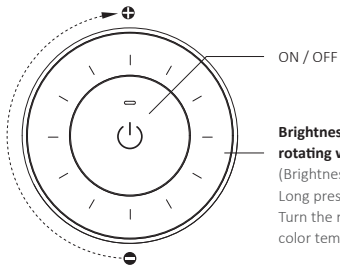

4. Install battery

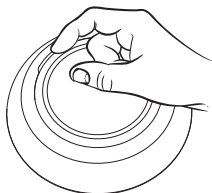

1. Open battery cover

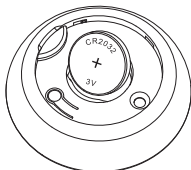

2. Install the battery as photo
(CR2032 Purchased separately)

5. Linking/Unlinking

Note: Remote need link with lights before control light.

Linking instruction

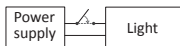

- 1 Turn off light after 10 seconds turn off

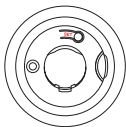

- 2 Short press "SET" 3 times within 3 second when the light on

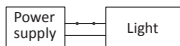

- 3 Light flashing 3 times slowly means it is successfully



Linking failed if light is not blinking slowly, Please follow above steps again.

(Note: Light that have linked can't link again)

Unlinking instruction

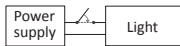

- 1 Turn off light after 10 seconds turn on



- 2 Short press "SET" 5 times within 3 second when the light on



- 3 Light flashing 10 times slowly means it is successfully



Unlinking failed if light is not blinking quickly, Please follow above steps again.

(Note: Light haven't linked that don't need to unlink)

6. Installation Notes

K3

Method 1

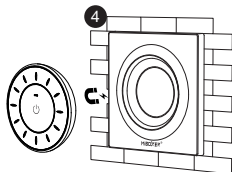
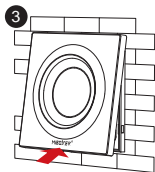
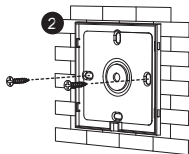
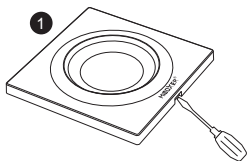

Method 2

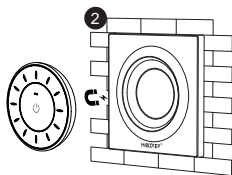
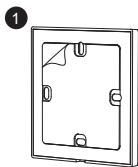

Take off the double-sided tape on the back of the base

Stick the base well, and the remote control is magnetically attracted to the base

K3S

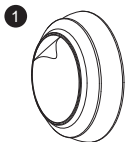

Take off the double-sided tape
on the back of the base

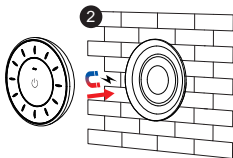

Stick the base well, and the
remote control is magnetically
attracted to the base

7. Attention

1. This remote only control specified Mi-Light / Miboxer products; details please check manual.
2. This remote control is a precision electronic product, please do not use it in a humid or high temperature environment for a long time. When not in use for a long time, please take out the battery and store it in a dry, static-free environment.
3. Do not use the remote control in a large area of metal or in an environment with strong electromagnetic waves nearby, otherwise the control distance will be seriously affected.



Made in China